

5/8" x 3/8"
15,875 x 9,65 mm

Pas lant: 15,875 mm

Latime interioara lant: 9,650 mm

Diametru rola lant: 10,16 mm

Raza dinte "r": 16,0 mm

Latime raza "C": 1,6 mm

Latime dinte "L": 9,0 mm

Latime dantura "h2": 25,5 mm

Material: otel C45E-UNI EN 10083-1

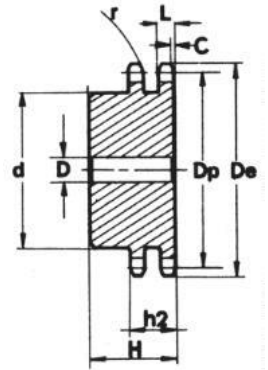

Z (numar de dinti)	Cod	De (mm)	Dp (mm)	d (mm)	D (mm)	H (mm)
8	PD 10008	47,0	41,48	25	12	40
9	PD 10009	52,6	46,42	30	12	40
10	PD 10010	57,5	51,37	35	12	40
11	PD 10011	63,0	56,34	39	14	40
12	PD 10012	68,0	61,34	44	14	40
13	PD 10013	73,0	66,32	49	14	40
14	PD 10014	78,0	71,34	54	14	40
15	PD 10015	83,0	76,36	59	14	40
16	PD 10016	88,0	81,37	64	16	45
17	PD 10017	93,0	86,39	69	16	45
18	PD 10018	98,3	91,42	74	16	45
19	PD 10019	103,3	96,45	79	16	45
20	PD 10020	108,4	101,49	84	16	45
21	PD 10021	113,4	106,52	85	16	45
22	PD 10022	118,0	111,55	90	16	45
23	PD 10023	123,4	116,58	95	16	45
24	PD 10024	128,3	121,62	100	16	45
25	PD 10025	134,0	126,66	105	16	45
26	PD 10026	139,0	131,70	110	20	45
27	PD 10027	144,0	136,75	110	20	45
28	PD 10028	148,7	141,78	115	20	45
29	PD 10029	153,8	146,83	115	20	45
30	PD 10030	158,8	151,87	120	20	45
31	PD 10031	163,9	156,92	120	20	45
32	PD 10032	168,9	161,95	120	20	45
33	PD 10033	174,5	167,00	120	20	45
34	PD 10034	179,0	172,05	120	20	45
35	PD 10035	184,1	177,10	120	20	45
36	PD 10036	189,1	182,15	120	20	45
37	PD 10037	194,2	187,20	120	20	45
38	PD 10038	199,2	192,24	120	20	45
39	PD 10039	204,2	197,29	120	20	45
40	PD 10040	209,3	202,34	120	20	45
42	PD 10042	219,9	212,44	120*	25	59
45	PD 10045	235,0	227,58	120*	25	59
46	PD 10046	240,1	232,63	120*	25	59
48	PD 10048	250,2	242,73	120*	25	59
50	PD 10050	260,3	252,82	120*	25	59
55	PD 10055	285,5	278,08	120*	25	59
57	PD 10057	296,0	288,18	120*	25	59
60	PD 10060	310,8	303,32	120*	25	59
76	PD 10076	392,1	384,16	120*	25	59
95	PD 10095	488,5	480,14	145*	30	58